



**HALL MEAD**  
SCHOOL



# Maps & Classrooms

*Year 7 Transition*

# There are 4 main buildings at Hall Mead School



**A Block : DT, Drama, FT, Art, Music, English, Science, Library, Head of house and Languages**

**B Block: Maths, Geography, History and ICT**

**Alan Wunderly Centre: RE/PSHE and ICT room**

**PE : Sports hall and Active studio**

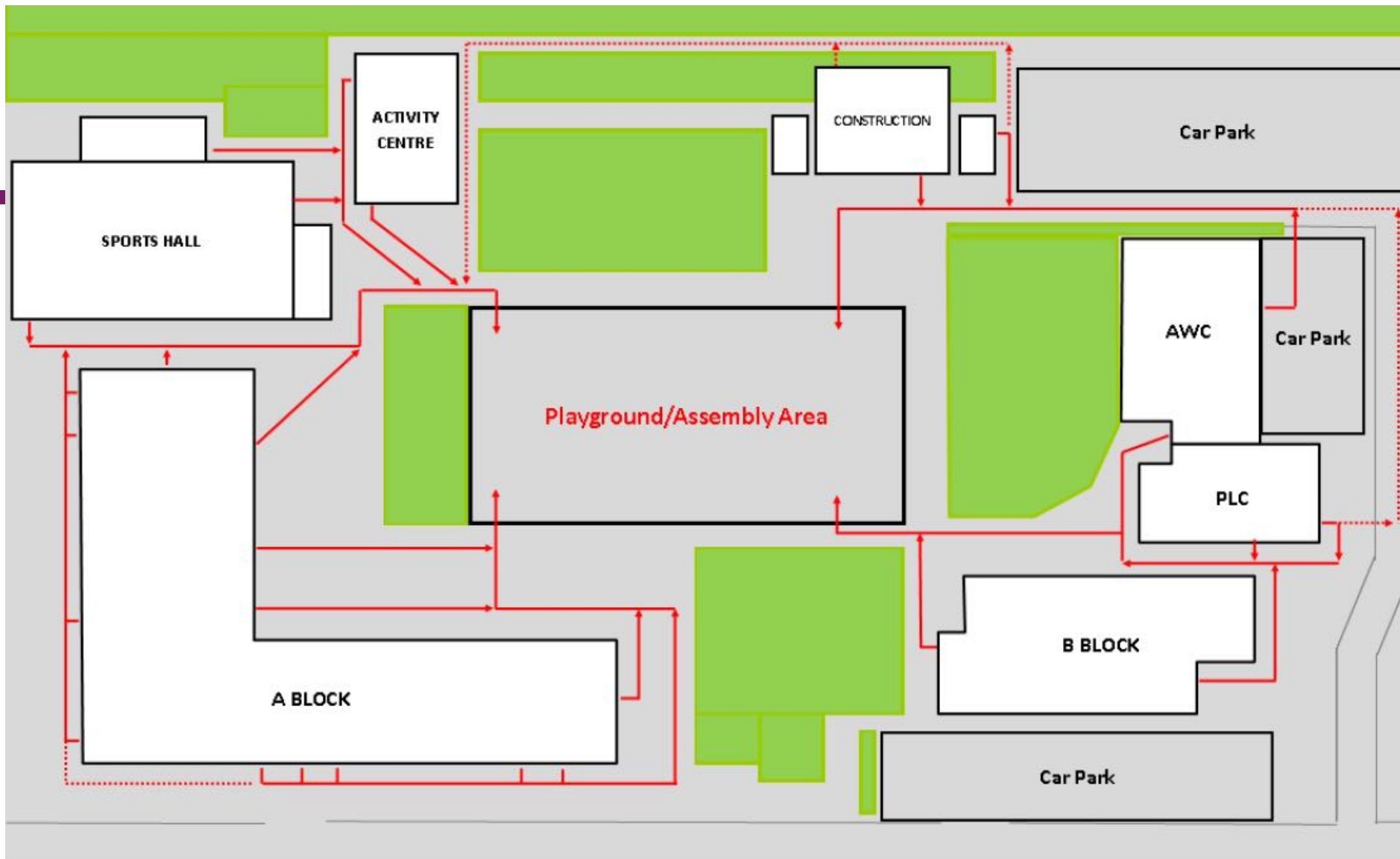

Map of Hall Mead School

— Evacuation routes

..... Alternative evacuation routes

# Lunch zones

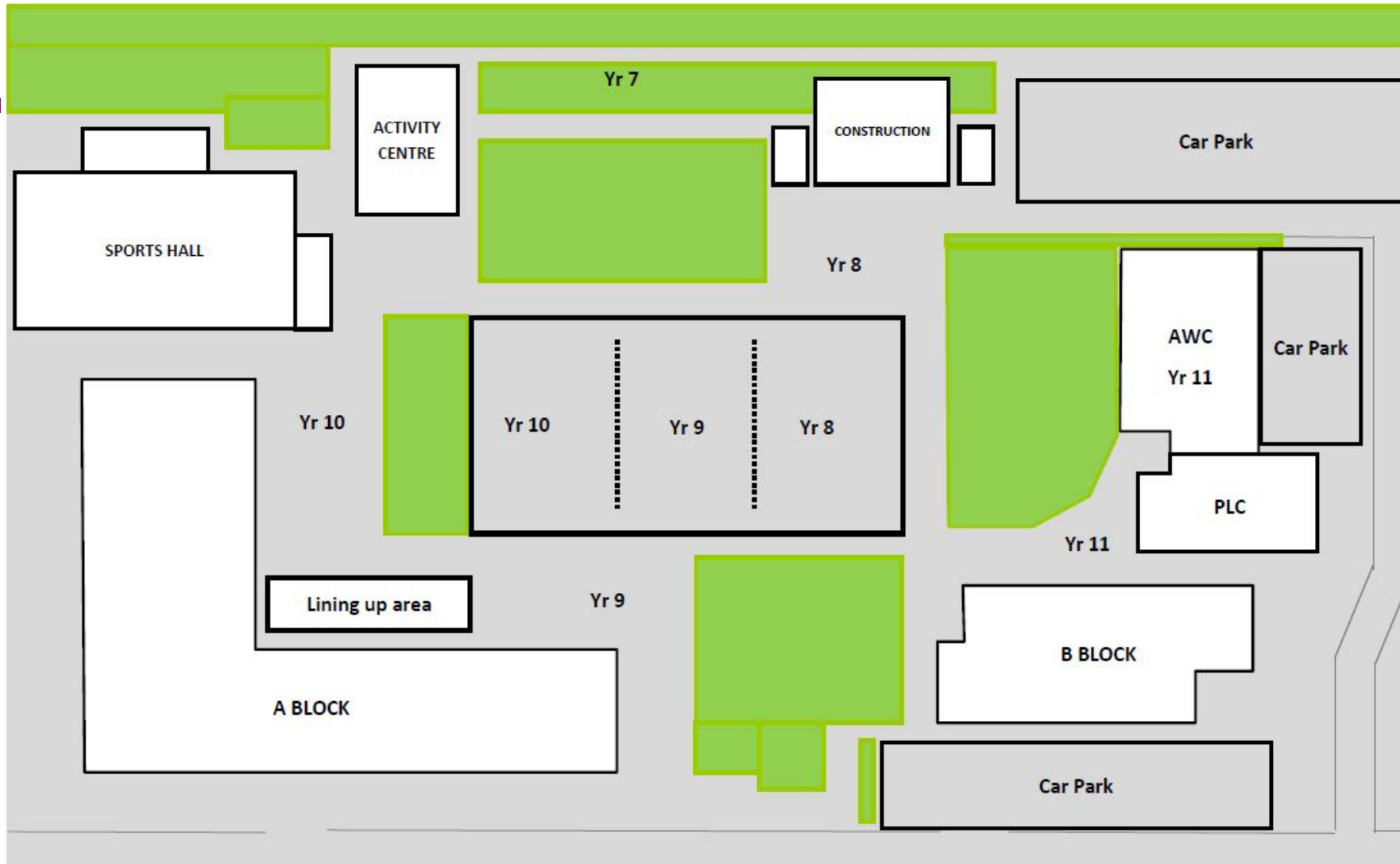

# Main Entrances



Main reception



Student entrance

# A block

## Ground floor:

Reception

Food Technology

Design Technology

Drama

Canteen

Main Hall

## First floor:

Music

Art

English

Library

Head of House

## Second floor:

Languages

Science



2022/06/14 11:09:52

# Main Hall



**HALL MEAD**  
SCHOOL



2022/06/14 11:10:06



**EMPOWER**  
LEARNING ACADEMY TRUST

# Music



# Drama studio



**HALL MEAD**  
SCHOOL





# DT room



# Science room



# English room



# B Block

**Ground floor:**  
Mathematics

**First floor:**  
History  
Geography  
PLC flat

**Second Floor:**  
ICT  
Student Support (Mr Cole and Mrs Seager)



# Computing



# History



# Mathematics corridor /classroom



# Alan Wunderly Centre

Ground floor:  
RE/PSHE rooms  
ICT room



# Alan Wunderly classroom/corridor



# PE

Sports hall –badminton, basketball, indoor football, short tennis, table tennis

Activity studio- Trampolining, gymnastics, table tennis, high jump, dance, yoga





# PLC

Ground floor:  
Reception  
Garden

Second floor:  
Mr O'Neil



# School field/ memorial garden and fish pond



**HALL MEAD**  
SCHOOL



**EMPOWER**  
LEARNING ACADEMY TRUST